

## 05

*Merricks Beach*  
**HOUSE**  
 by Kennedy  
Nolan Architects

• MORNINGTON PENINSULA, VIC •

This beach house encourages a delight in the basic act of living – it is somewhere to enjoy the company of friends and family, away from the pressures of the city.

Words by [Katelin Butler](#)  
 Photography by [Derek Swalwell](#)

**A** beach house is a place where the daily acts of life can be relished. Instead of rushing to get the food on the table after a busy day at work, you can spend all day cooking and preparing for an evening meal. Instead of flicking the switch on the heater when you get home, you might collect kindling for the wood fire, which involves a stroll to the beach and back. The Merricks Beach House by Kennedy Nolan Architects is somewhere one can indulge in such mindfulness about the act of living.

Merricks Beach is just over an hour's drive from Melbourne – an easy weekend getaway. Although not in the city, the small towns dotted along the coastline appear suburban in layout. This house is located on a block of land with a north-south orientation. As you



01 The scale of the street elevation is difficult to gauge at first, appearing as if it might be two levels.



approach, the house appears from behind a planted mound. The scale of the project is hard to gauge at first. As architect and owner Rachel Nolan comments, "I've enjoyed making a little big house, or a big little house." With painted brickwork below and boxed-out timber above, it appears as if it might be a double-storey house. On entry, however, you realize that it really is a modestly sized beach house, "a very clipped little creature," as Rachel says.

A courtyard takes pride of place within the home. It allows the northern light to fill the living spaces at the southern end of the site. The streets in Merricks are unsealed, which creates lots of dust on the northern edge of the property, so the courtyard plan works well for this reason, too. Keeping in mind that visitors don't formally arrive at a beach house, the main entry leads you into this courtyard from the carport. A concertina concrete block wall within the courtyard leads the way to the "front" door, even though it feels like you might be entering from the back door. Approaching the house through the courtyard provides an opportunity to see into the house before you enter, which makes the living spaces almost appear as a stage set for family life.

Priority has been given to the size of the living spaces, so sleeping spaces are compact: there are two small bedrooms and an open-plan bunk room. The spatial configurations within the house have been carefully considered, and functions aren't necessarily divided by walls. Rachel has delineated spaces by introducing level changes, varying ceiling heights and using the contrast between light and dark spaces to good effect. For example, the bunk room is open to the corridor, and is deliberately a very dark space. This contrasts with the corridor, which is well lit by a large window to the north. In another example, a sunken pit defines the edge of the living space and the step-down creates an extra seating area or even sleeping space. These gestures rethink the way thresholds are defined, and create a series of flexible and usable in-between spaces.

The kitchen has been designed to reflect the "heightened domesticity" that takes hold at a holiday house, especially during winter. The act of cooking becomes a key part of the day, so a good-sized kitchen was important to Rachel. The kitchen bench is 850 millimetres deep, making the space feel generously proportioned. An enclosed barbecue deck flanks the kitchen and opens out to the

02 A sunken pit defines the living space, with a fireplace positioned strategically between this and the kitchen.

03 All the in-between spaces can be given a function, making a small space work hard.





backyard to the south. This enclosed deck can be opened up during the warmer months, adding extra space to the interior. Rachel was interested in the idea of pulling your house “in tight in winter and expanding it out in summer.” This is also evident in the courtyard space – in the summer months, with the sliding doors completely open, this becomes a primary living space.

The basic material palette for this house comprises recycled brick and locally milled timber, which will turn grey as it weathers. The brick has been painted white on all walls, apart from a circle with a 1800-millimetre diameter. This circle of recycled red bricks embeds a form of decoration into the walls: further adornment is not needed. The circle is mirrored externally, as if it punctures through the wall, also giving interest to the rear elevation. Exposed concrete flooring is used within the kitchen and circulation spaces and provides good thermal mass during the winter months.

This house is set up so that you can go down on a Friday night

and immediately enjoy it. Although this is Rachel’s own family holiday home, it is also going to be used as a rental property. This fact played a key role in many of the design decisions and material choices. In addition, Rachel intended to bring other families and friends to the house, which also aided in the decision-making process. For example, the bunk room can function as a secondary living space for the children while the adults are out the back. The bathroom planning also takes sharing into consideration, with all functions separated so that someone can shower while others brush their teeth. In this arrangement, there isn’t the need for more than one bathroom.

As Rachel says, “architecture is one thing, but having everyone in the house is what animates the spaces to makes it warm and welcoming.” Having people over to enjoy the spaces was of utmost importance to the design of this beach house, and it is sure to be a place of many fun family memories. 



04 In the summer months the courtyard becomes a primary living area.

05 The contrast between light and dark is used to define the edges of different functions.

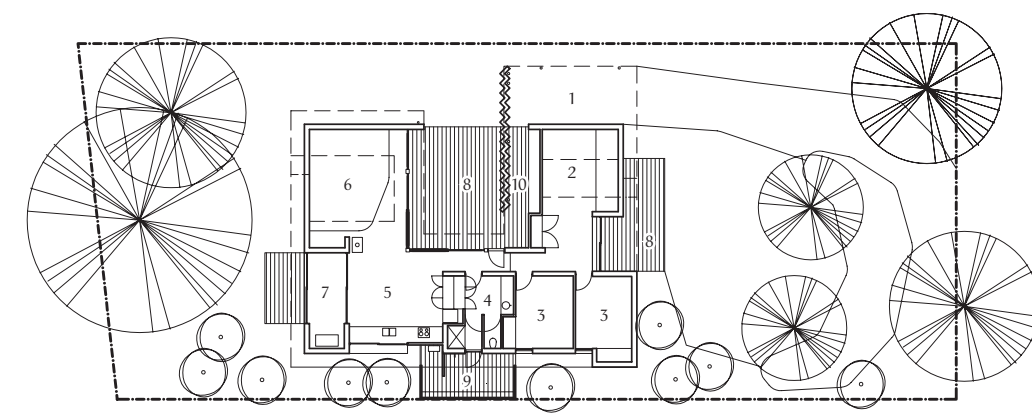

Ground floor 1:400

0 6 m 

- 1 Carport
- 2 Bunk
- 3 Bedroom
- 4 Bathroom/laundry
- 5 Kitchen/dining
- 6 Living
- 7 Barbecue
- 8 Deck
- 9 Service deck
- 10 Entry/storage

06 The bunkroom is a dark space, which acts as a fun play space for the children.



#### Architect

**Kennedy Nolan Architects**  
195a Brunswick Street  
Fitzroy Vic 3065  
+61 9415 8971  
[email@kennedynolan.com.au](mailto:email@kennedynolan.com.au)  
[kennedynolan.com.au](http://kennedynolan.com.au)

#### Practice profile

A design-focused practice that works principally on residential projects, ranging from alterations and additions to multiresidential builds.

#### Project team

Rachel Nolan, Patrick Kennedy, Michael Macleod

#### Builder

Matt Johnson Building Services

#### Consultants

**Engineer:** Keith Long and Associates

#### Products

**Roofing:** Lysaght Custom Orb in Colorbond 'Jasper'  
**External walls:** Recycled red bricks with flush mortar painted Haymes 'Worn White'; undressed local mill hardwood fixed to plywood substrate

**Internal walls:** Timber lining boards and recycled red bricks with flush mortar, both painted Haymes 'Worn White'

**Windows:** Patron Windows hardwood timber windows with black satin finish

**Flooring:** Polished concrete slab with clear seal; Hycraft Carramar carpet in 'Coal Ash'

**Lighting:** Masson For Light

**Kitchen:** Miele gas cooktop, oven, exhaust and dishwasher; Homestead Cabinets and Furniture benchtop with integrated sinks; door and drawer fronts in black laminate with solid timber edge strip and pantry doors in white laminate; Academy Tiles white hexagonal ceramic tile splashback; Reece Yeva chrome mixer

**Bathroom:** Porcher Cygnet toilet; Mizu basin; Reece Yeva shower mixer; Sussex Pol Rail Shower shower head; Homestead Cabinets and Furniture joinery in white laminate with solid timber edge strip

**Heating and cooling:** Nectre slow combustion wood fire; Hunter Pacific Concept 2 ceiling fans

#### Floor area

850 m<sup>2</sup> site  
155 m<sup>2</sup> floor

#### Project cost

\$450,000

#### Time schedule

**Design, documentation:**

6 months

**Construction:**

9 months